

Piedmont Sofa

PT-502

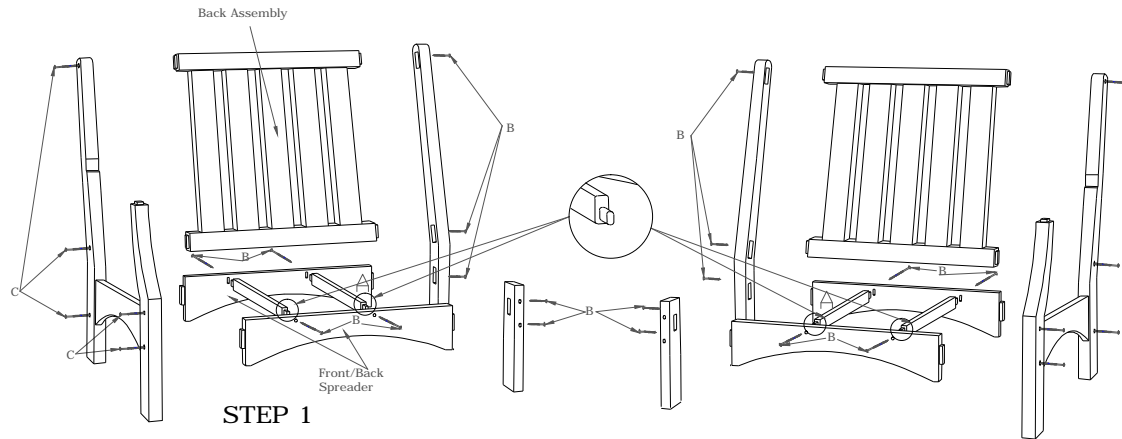

STEP 1

Attached Back Spreader to Right Side Assembly and Back Center Leg. The spreader should have the Letter "A" side attaching to the Back Center Leg as shown. Attach the Front Spreader to the Front Center Leg. Again the spreader should have the letter "A" side attaching to the Front Center Leg. Attached with screws "C" on the side assemblies and screws "B" on the front and back center legs. Insert support braces as shown and attach with screws "B". Place the back assembly so that the tenons on the assembly fit into the pockets on the Side Assemblies as shown. Attach with screw "C".

BREEZESTAtm Recycled Poly Furniture

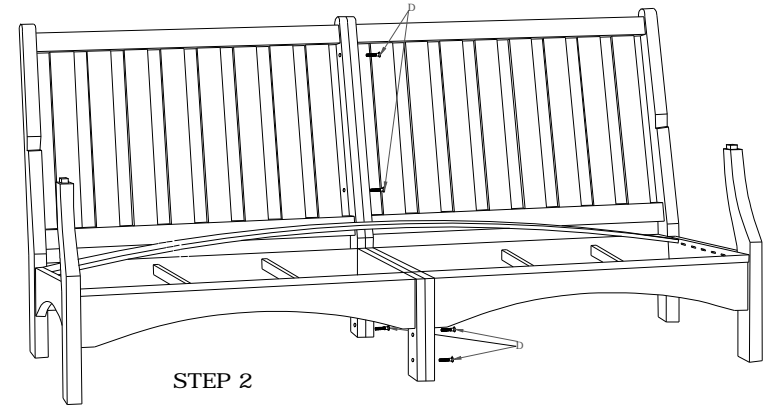

STEP 2

Join both left and right assemblies with screws "D" as shown below. Insert slats by placing in one end, bowing in the middle slightly and allowing to expand into mortise pocket on opposite side. Attached with colored screws "B" as shown.

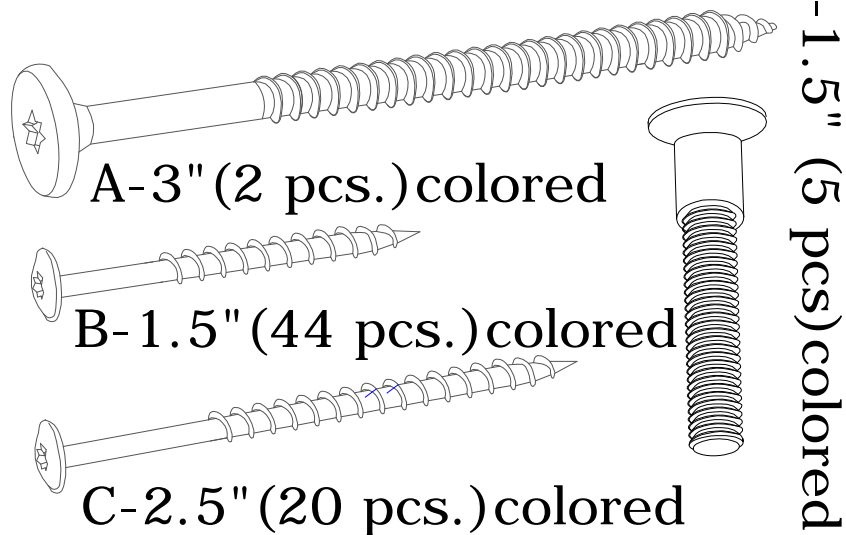

LIST OF PARTS

Side Assemblies (1 right, 1 left)
Front Cntr Legs (1 right, 1 left)
Back Cntr Legs (1 right, 1 left)
Support Braces (4)
Arm Rest (1 right, 1 left)
Front / Back Spreaders (4)
Back Assemblies (2)
Seat Slats (6)
Colored Screws "A" (2)
Colored Screws "B" (44)
Colored Screws "C" (20)
Colored Screws "D" (5)
Insert Bit Tool (1)

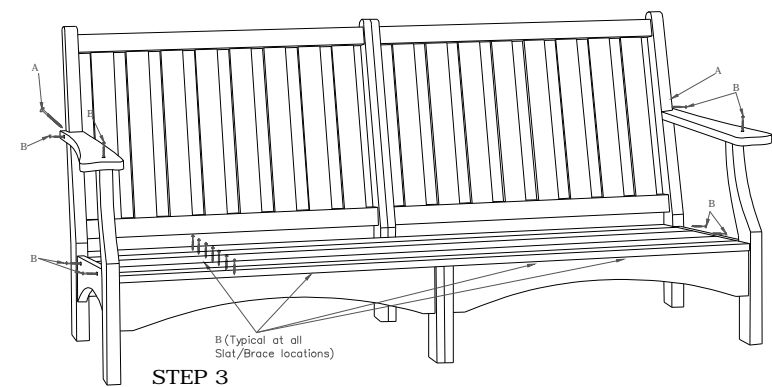

STEP 3

Using Screws "B" attach the slats to the under supports. Place the armrests over the tenons in the front of the side assemblies. Attach through the top and sides with screws "B". From the back screw through the back assembly into the arms with screws "A".