

# RIDGELINE GLIDER BENCH PAGE 2

## RL-0201

**BREEZESTA<sup>™</sup>**  
Recycled Poly Furniture

### LIST OF PARTS

- Left End Assembly (1)
- Right End Assembly (1)
- Rails (2)
- Spreaders (36" Glider 1)  
(48" Glider 2)  
(60" Glider 3)
- Colored Screws "A"  
(36" Glider 8)  
(48" Glider 8)  
(60" Glider 8)
- Lag Screws "B" (4)
- Washers "C" (4)
- Colored Screws "D"  
(36" Glider 2)  
(48" Glider 4)  
(60" Glider 6)

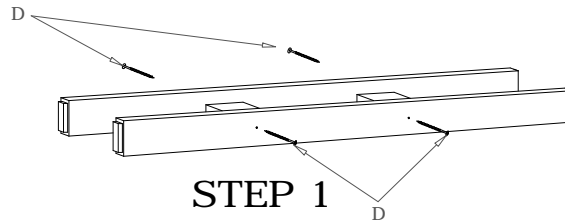

Attached Rails to Spreaders using screws (D) as shown.

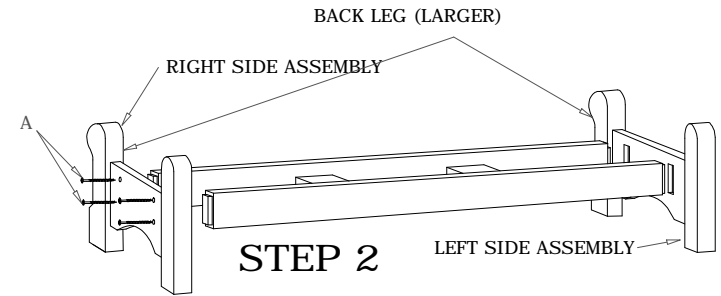

Attach Right and Left Side Assemblies with screws (A) as shown.

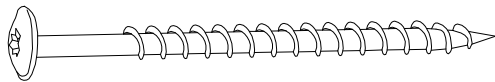

**A-2.5" colored**

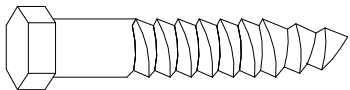

**B-1.75" uncolored**

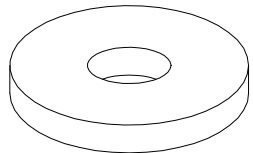

**C-Washer**

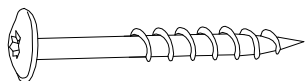

**D-1.5" colored**

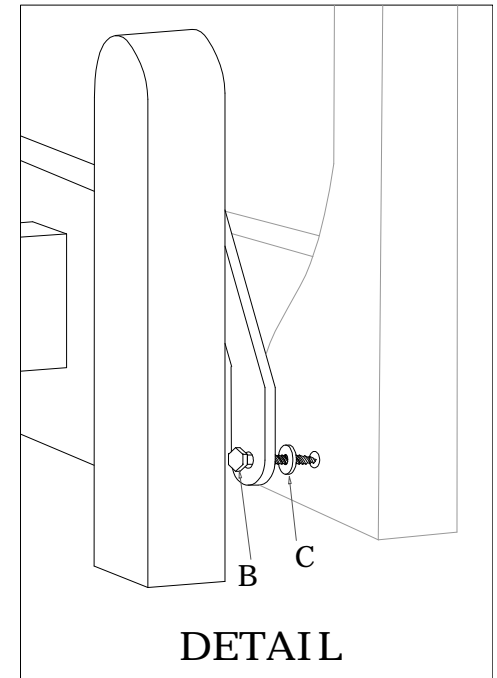
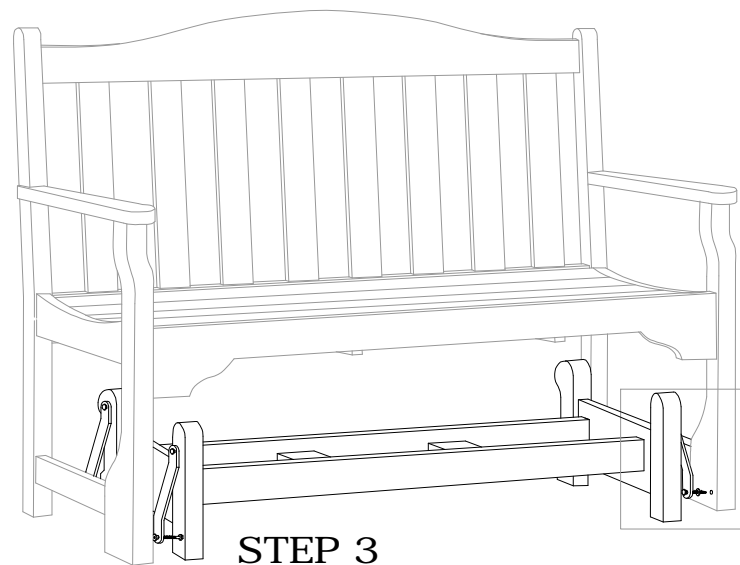

Slide Glider Assembly under bench with large feet to the rear. Attach Glider Arms to Bench using Lag Screws (B) and Washers (C) as shown in Detail 2.