

PARTS			
PART	DESCRIPTION	PART NO.	QTY.
A	LH BACK LEG ASSEMBLY	SA-00423	1
B	RH BACK LEG ASSEMBLY	SA-00424	1
C	LH FRONT LEG	PRT-00755	1
D	RH-FRONT LEG	PRT-00756	1
E	SEAT ASSEMBLY	SA-00429	1
F	LH ARM ASSEMBLY	SA-00427	1
G	RH ARM ASSEMBLY	SA-00428	1
H	SPREADER	PRT-00754	1
I	BACK ASSEMBLY	SA-00439	1

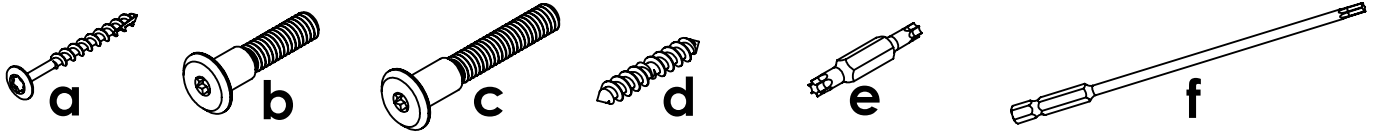

SA-00444 HARDWARE KIT			
PART	DESCRIPTION	PART NO.	QTY.
a	#8 x 1-3/4 TORX SCREW	H-0000-S8175	4
b	5/16"X1-1/2" CHAIR BOLT	H-0000-CB51615	8
c	5/16"X2-1/8" CHAIR BOLT	H-0000-CB516218	6
d	DOUBLE SCREW	H-0000-DS	4
e	T20 & T25 TORX BIT	H-0000-CTD	1
f	6-INCH T20 TORX BIT	H-0000-T20X6	1

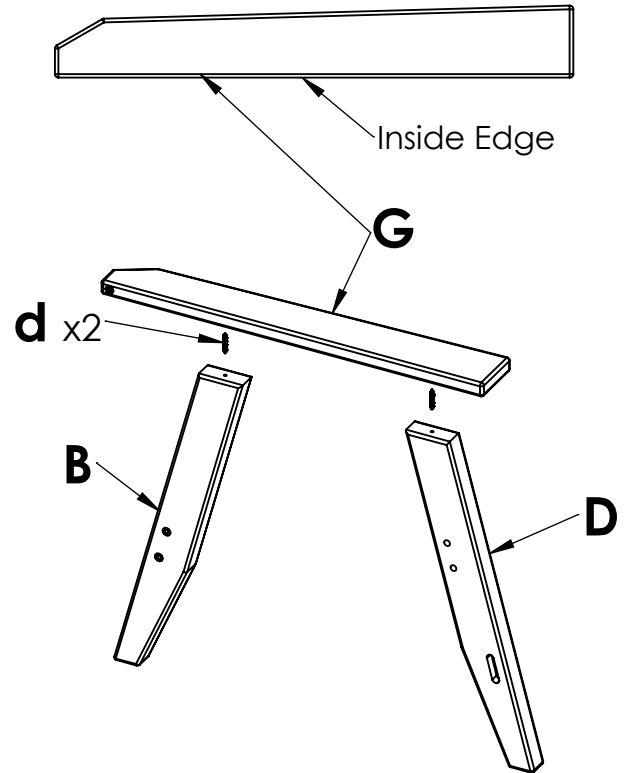
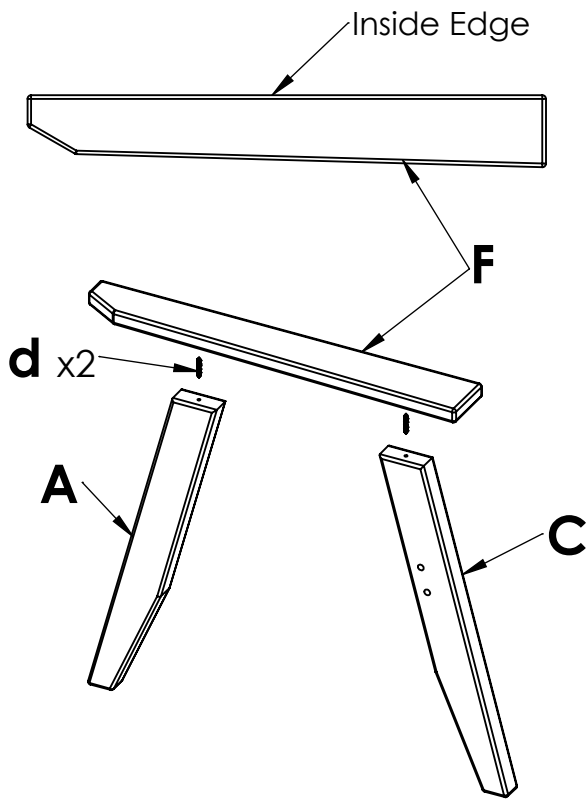

1. Start an end of a double screw (d) in the hole in the top of each leg. Thread the opposite end of the double screw into the corresponding arm, turning the legs clockwise to tighten, until the top of the leg is tight and flush with the bottom of the arm. The slots/threaded inserts in the legs should face toward the inside edge of its corresponding arm.

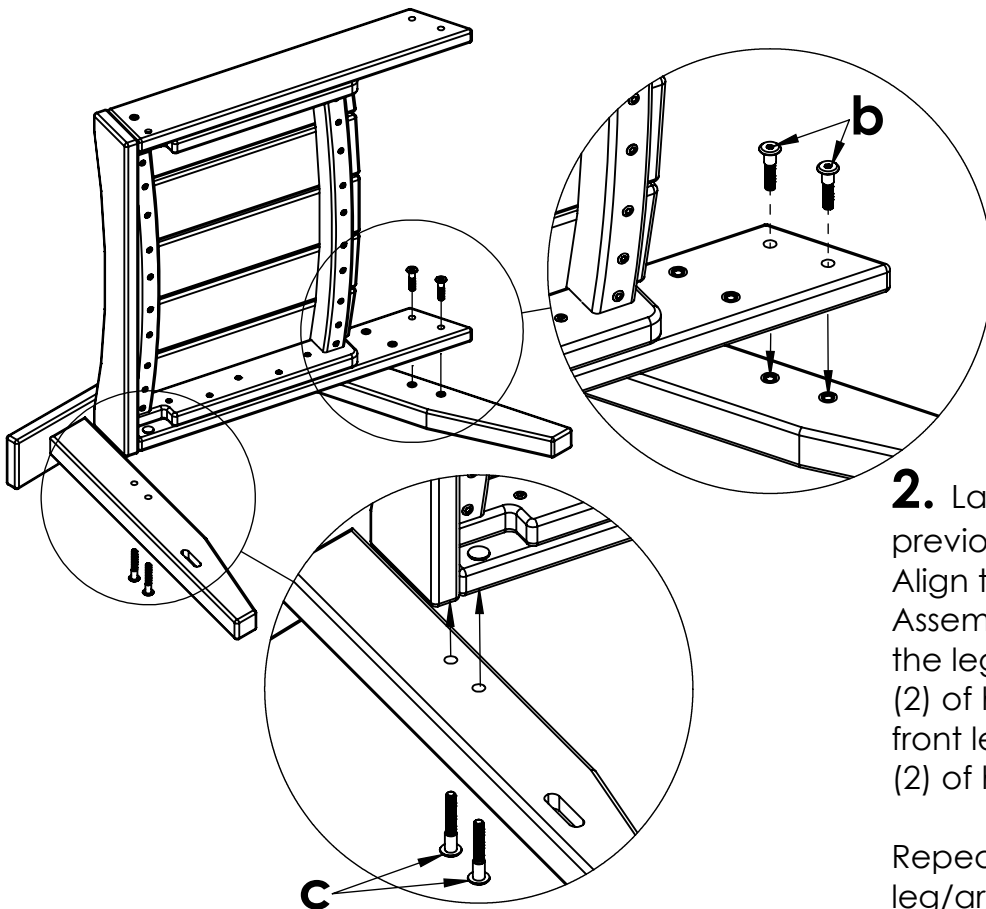

2. Lay a leg/arm assembly from the previous step on a non-marring surface. Align the side rail holes of the Seat Assembly (E) with the threaded inserts in the legs. Fasten the Seat Assembly using (2) of hardware b in the rear leg. Lift the front leg end of the chair and fasten with (2) of hardware c.

Repeat the process to attach the opposite leg/arm assembly.

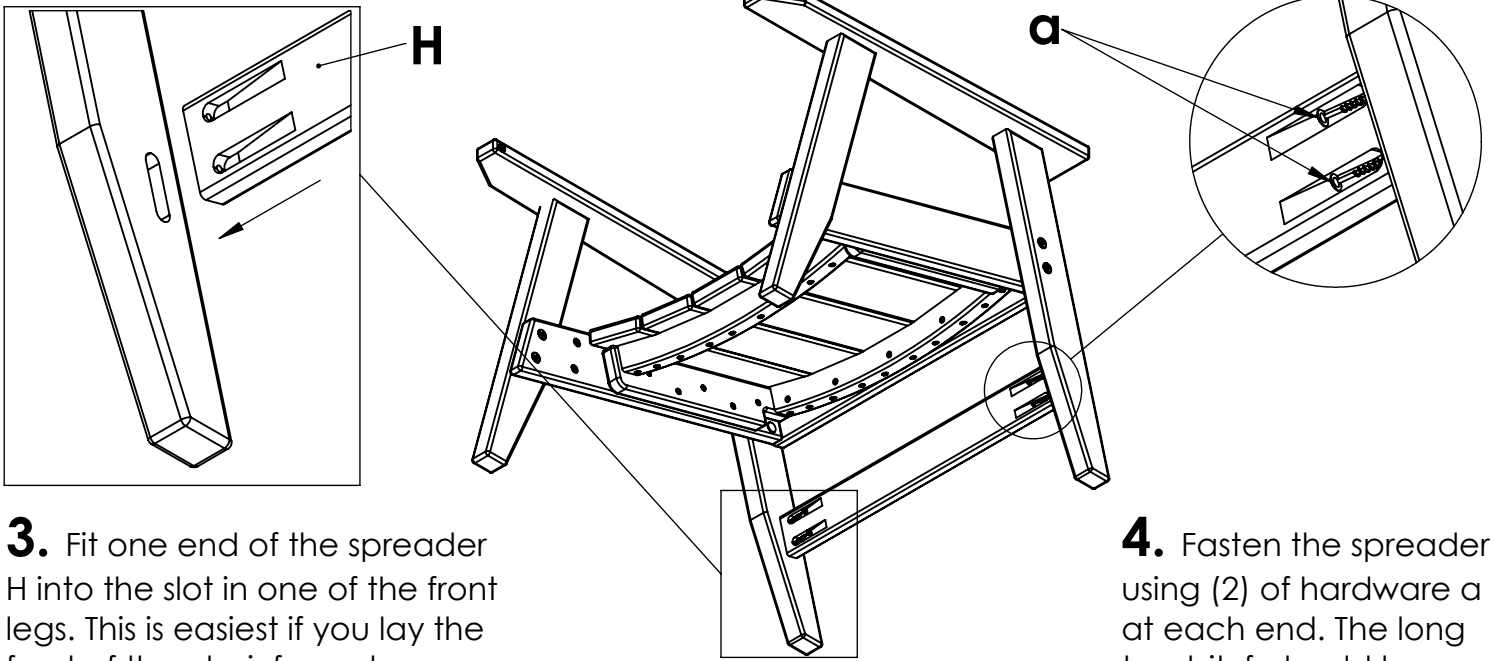

3. Fit one end of the spreader H into the slot in one of the front legs. This is easiest if you lay the front of the chair face down on a non-marring surface. Using some outward pressure on the opposite leg, push the spreader into place on the opposite side so it pops into the slot in that leg.

4. Fasten the spreader using (2) of hardware a at each end. The long torx bit, f, should be used to install these screws.

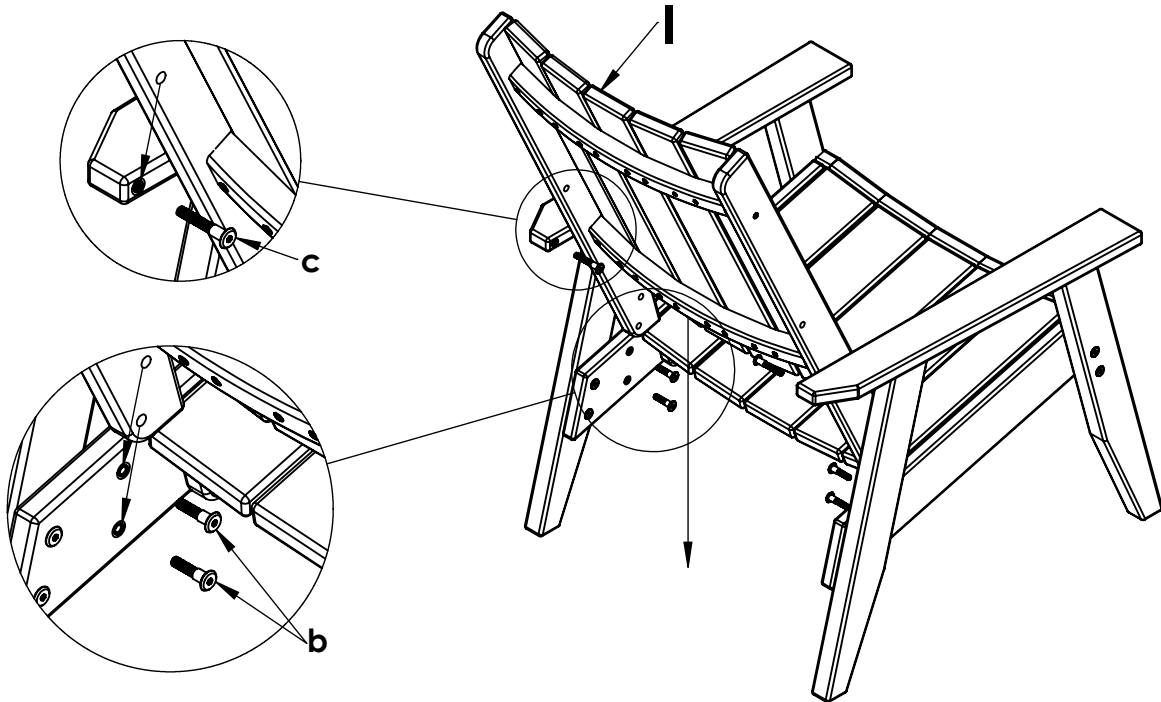

5. Stand the assembly from Step 4 upright as shown. Slide the Back Assembly I down between the arms/seat rails. Hand tighten (1) of hardware c into each of the arm holes - this will allow the back to pivot and align with the holes in the back rails/seat rails. Align the holes in the back rails with the threaded inserts in the seat rails. Hand-tighten (2) of hardware b in the two lower holes on each side. Once all bolts are in place, tighten with a drill/driver.